

COMPANY NAME \_\_\_\_\_ PHONE \_\_\_\_\_  
CONTACT \_\_\_\_\_ ACCOUNT NO. \_\_\_\_\_ FAX \_\_\_\_\_  
JOB NAME \_\_\_\_\_ EMAIL \_\_\_\_\_

QUOTE     ORDER P.O. # \_\_\_\_\_ DATE \_\_\_\_\_

**MODEL / RATING**

- Light Interlock (Interior Use)
- Heavy Interlock (CW40 Rating) Exterior Use

**GLAZING**

- By Others
- By C.R. Laurence Specify (Color/Type)

**STANDARD HARDWARE FINISH**

- Brushed Stainless Steel
- White Painted
- Black Painted

**FINISHES**

- Available color/finish options:
- WH - White Powder Paint Traffic White RAL9016
  - BL - Glossy Black Powder Paint Jet Black RAL9005
  - MBL - Matte Black Lava PU19115
  - DU - Black Bronze Anodized - Class 1
  - SA - Satin Anodized - Class 1
  - PT - Custom Powder Paint

**LEAD STILE**

- Single Handle Lead Stile
  - Double Handle Lead Stile (BTB)
- DOUBLE LEAD STILE IS STANDARD**

**SILL TYPE**

- Raised Track
  - Flush Track\*\*
- \*\*Trench Drain (By others) recommended for Exterior Application

**LOCKING**

- 2 Point Surface Catch

**NOTE: Kynar not available for P100S Model**

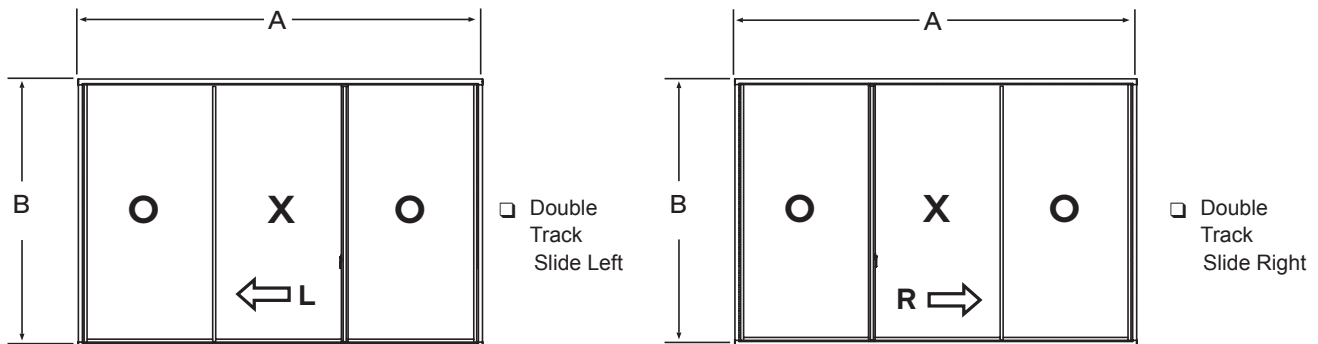
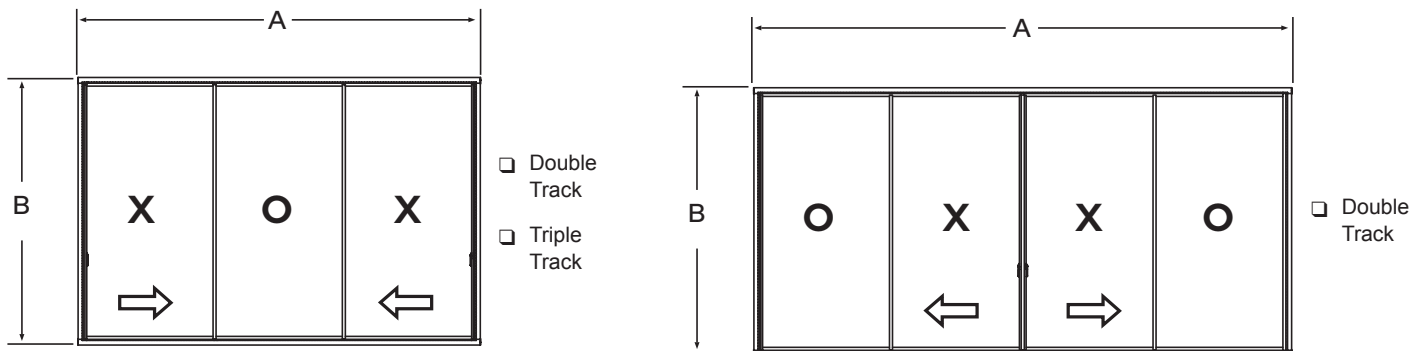
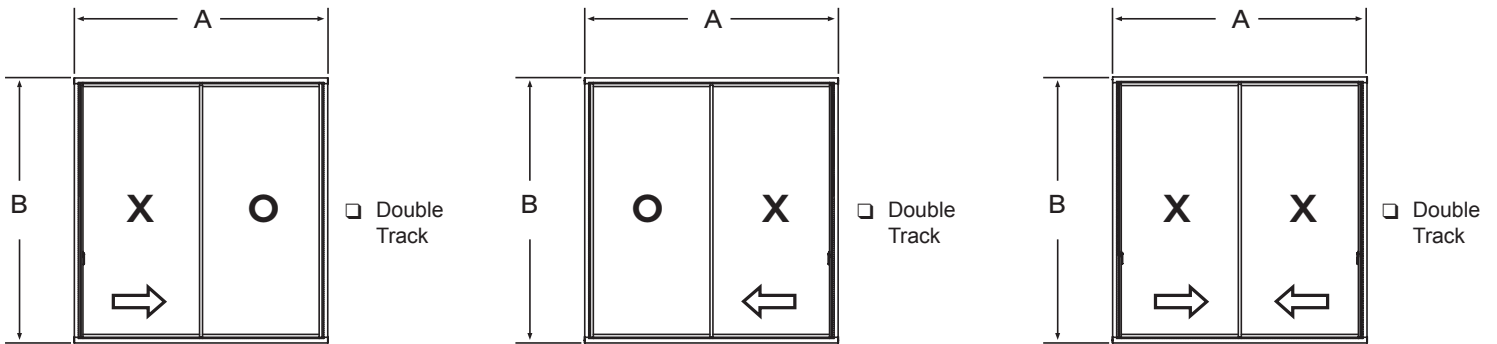

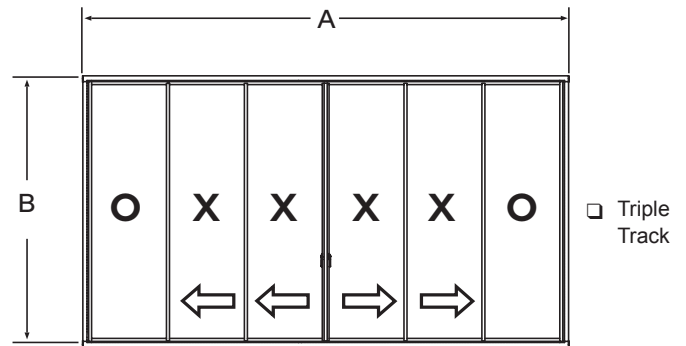
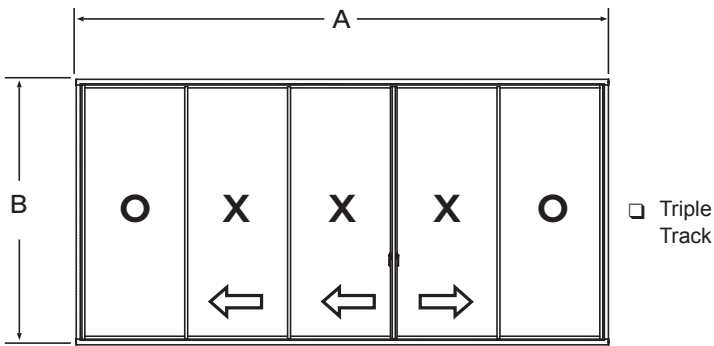
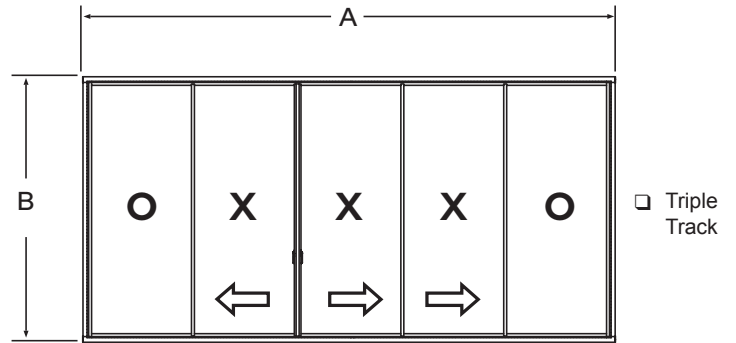
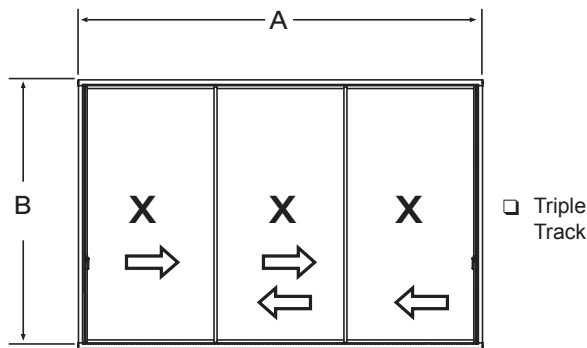
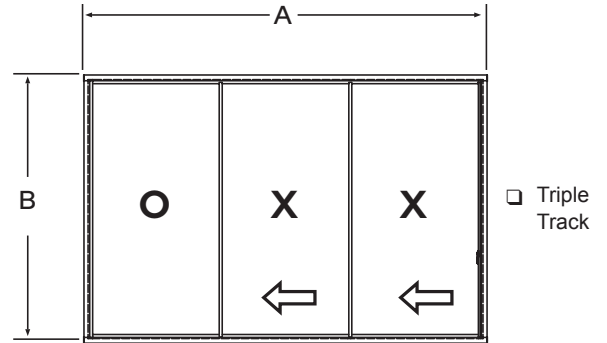
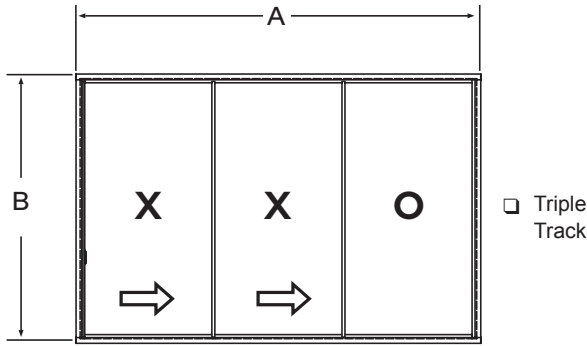

**NOTE: SYSTEM VIEWS ARE FROM INTERIOR LOOKING OUT**

MARK	QTY	DIM A (WIDTH)	DIM B (HEIGHT)

FOR OFFICE USE ONLY	
TAKEN BY:	_____
PRICED BY:	_____
EDITED BY:	_____

APPROVED BY \_\_\_\_\_ DATE \_\_\_\_\_

**NOTE: PLEASE DOWNLOAD FORM TO SUBMIT. DO NOT FILL FORM ONLINE.**  
Email completed form to [entrance.partitions@crlaurence.com](mailto:entrance.partitions@crlaurence.com).  
This form is available online at [crlaurence.com](http://crlaurence.com).

SECTION DETAILS

NET FRAME WIDTH

LEAD STILE OPTIONS

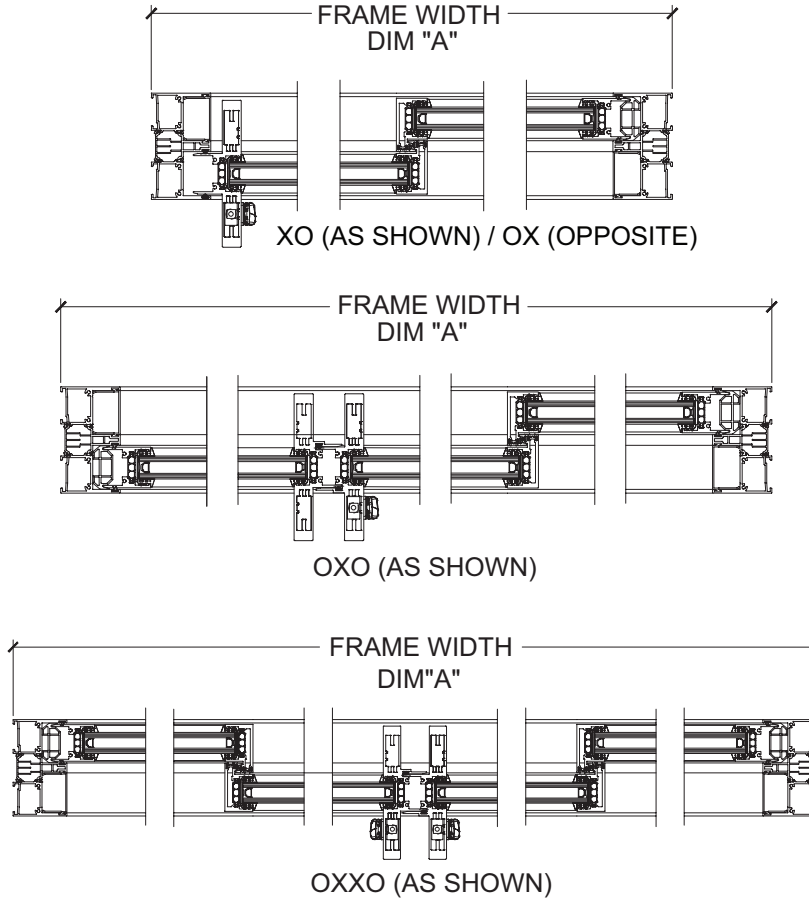
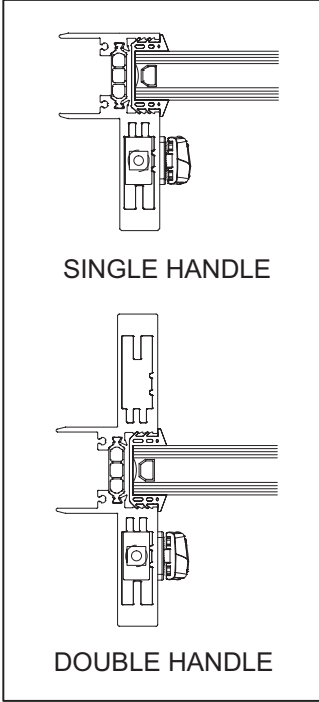

INTERLOCK OPTIONS

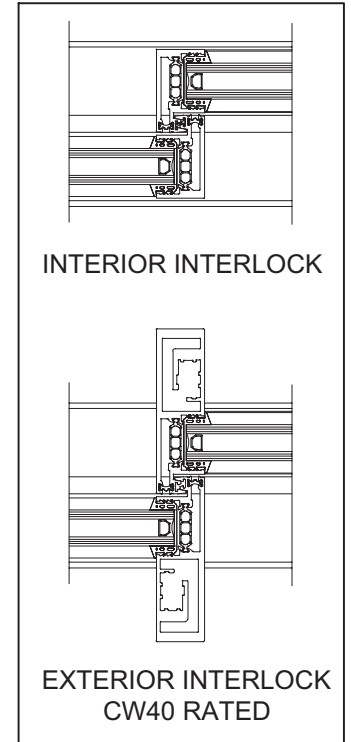

NET FRAME HEIGHT

DOUBLE TRACK

TRIPLE TRACK

